

# ZONING

<b>HB</b>	HIGHWAY BUSINESS
<b>GB</b>	GENERAL BUSINESS
<b>HI</b>	HEAVY INDUSTRIAL

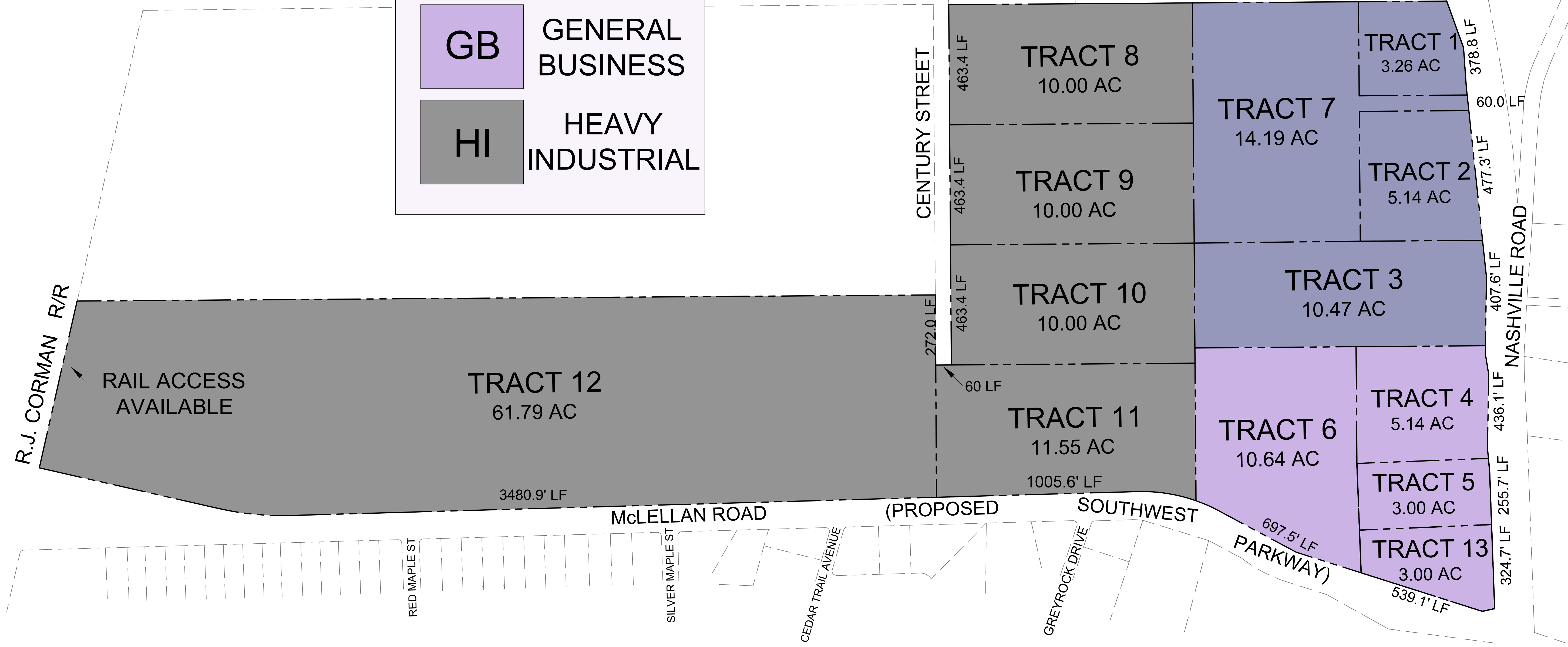

R.J. CORMAN R/R

RAIL ACCESS AVAILABLE

TRACT 12  
61.79 AC

3480.9' LF

McLELLAN ROAD

(PROPOSED

SOUTHWEST

PARKWAY)

NASHVILLE ROAD

**ACES**  
ARNOLD CONSULTING  
ENGINEERING SERVICES, INC.  
P.O. BOX 1338  
BOWLING GREEN, KY 42101  
PHONE (270) 780-9445

